

en

## Important notes

zh

## 重要提示

If the dishwasher is installed below or above other domestic appliances, follow the information for installation in combination with a dishwasher in the installation instructions for the particular appliances. Also follow the installation instructions for the dishwasher to ensure that all appliances are operated safely.

If there is no information or if the installation instructions do not include the appropriate information, contact the manufacturer of these appliances to ensure that the dishwasher can be installed above or below these appliances.

If you cannot obtain any information from the manufacturer, you must not install the dishwasher above or below these appliances.

If you install a microwave oven above the dishwasher, the microwave oven may be damaged.

Please follow the installation instructions (safety distances) if you install the dishwasher under a hob.

The minimum safety distance must not be less than 60 mm for gas and induction hobs and 65 mm for ceramic hobs.

If the installation instructions for the hob require greater minimum distances, these must be observed.

en

如果要洗碗机安装在其他家用电器的下面或者上面，则要遵照和洗碗机组合安装的相应家用电器的安装说明书进行安装。

为了确保各个组合安装的家用电器的使用安全性，请您在安装时也遵照洗碗机的安装说明书。

如果没有要和洗碗机组合安装的相应家用电器的安装说明书可用，请您和相应家用电器的生产厂商联系询问了解情况，以便确保可以将洗碗机安装在相应家用电器的上面或者下面。

如果您无法从家用电器的生产厂商获得有关信息资料，则不得将洗碗机安装在相应家用电器的上面或者下面。

如果在洗碗机的上面安装微波炉，则微波炉有发生损坏的可能。

若将洗碗机安装在平面炉下面，请遵照安装说明书（安全距离）。

将洗碗机安装在燃气灶或者电磁炉的下面时，必须有60毫米的最低安全距离，安装在玻璃陶瓷炉的下面时，

如果根据平面炉安装说明书的要求，必须有更大的安全距离，则必须满足相应安全距离的要求。

必须有65毫米的最低安全距离。

zh

**en** **Minimum safety distances only if installed beneath hob**  
(all models).

Unnecessary in other forms of installation (column,  
beneath work surface etc).

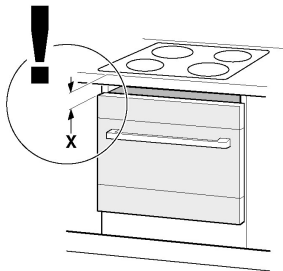

**en** **Place insulation layer** (only for those models where it is  
included) **only if installed beneath hob.**

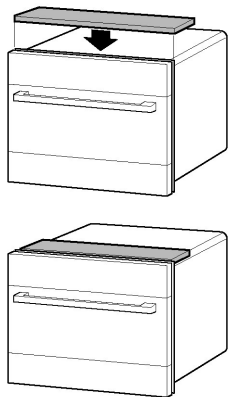

**zh** **最低安全距离仅在将洗碗机安装在平面炉** (所有各种型号)  
**的下面时才需要。**

在任何其它安装方式的情况下(机器上下重叠、安装在工作台  
面的下面等)则不需要。



**X**

- \* Gas/燃气炉 →  $X \geq 60 \text{ mm}$
- \* Induction/电磁炉 →  $X \geq 60 \text{ mm}$
- \* Glass ceramic cooktop/table/  
玻璃陶瓷炉 →  $X \geq 65 \text{ mm}$

**zh** **仅在将洗碗机安装在平面炉下面时，才需要安装隔热层**  
(只适用于在供货范围中包括有隔热层的洗碗机型号)。

